



## Internal Door & Screening System

### Overview

- Fixed screens
- Hinged doors
- Pivot doors
- Sliding doors
- Doors available as single or double
- Slim sightlines throughout range
- Concealed hinges
- 30mm fixed frame profile
- 57mm door profile
- Ideal for both domestic & commercial applications



## Key Features

- Ideal for both domestic and commercial projects
- Viewed from outside - **Outside is the side you are viewing the frame from**
- Full range of door configurations options using a single system
- Easy installation
- Minimal sightlines
- Handle options available
- Concealed hinges
- Available in any RAL colour
- Magnetic hold close as standard
- Concealed Shootbolts to slave of double hinged doors
- Soft open / close as standard on Sliding Doors (not available on Hinged or Pivot doors)
- Combination frames are split and coupled, horizontally and/or vertically.
- Horizontal couplers are continuous, vertical couplers are split (subject to style)
- Clearance from bottom of Hinged & Sliding doors to finished floor level **7mm**
- Clearance from bottom of Pivot doors to finished floor level **14mm**
- 58mm transom/mullion detail available for fixed frames and doors
- Duplex bar available 25mm & 41mm
- Single glazed 6mm - 12mm Toughened \*not all thicknesses supplied by Sternfenster
- Single glazed 6.8mm - 12.8mm Laminated \*not all thicknesses supplied by Sternfenster

## Max size for door leaves

- Single hinged door - 1000mm (w) x 2600mm (h)
- Double hinged door - 2000mm (w) x 2600mm (h)
- Single pivot door - 2200mm (w) x 2600mm (h)
- Double pivot door - 4400mm (w) x 2600mm (h)
- Single sliding door - 1200mm (w) x 2600mm (h)
- Double sliding door - 1000mm (w) x 2600mm (h)

**Profile**

**JID001 Door leaf**

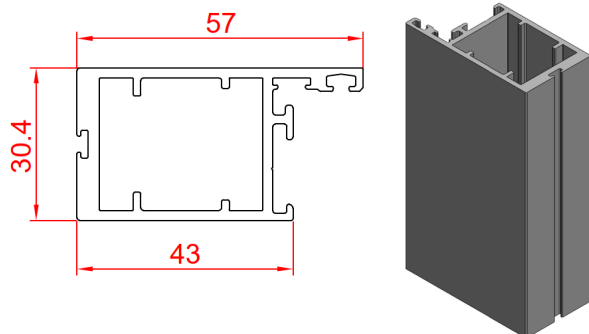

**JID003 Glazing Channel Door Outerframe**

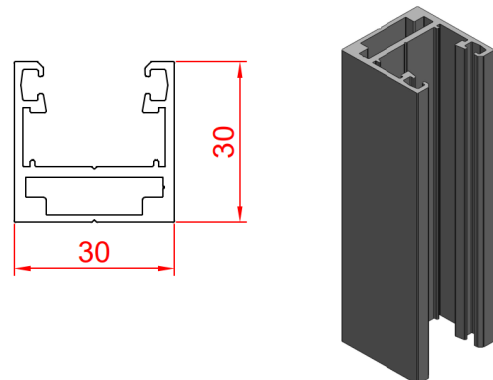

**JD164 Pocket Filler**

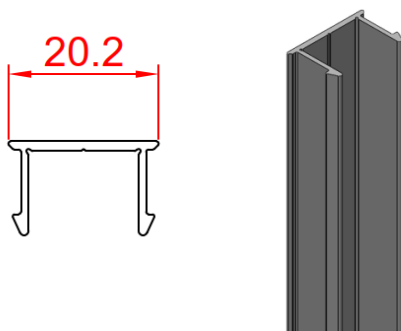

**SWB-007 Rebated Sash bead internal**

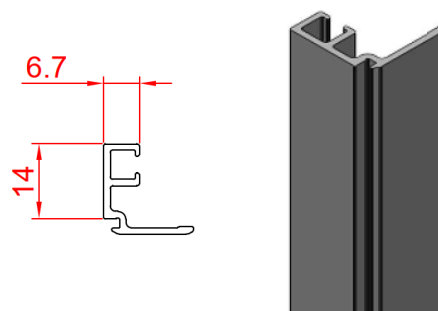

**JID013 Door sash transom / mullion**

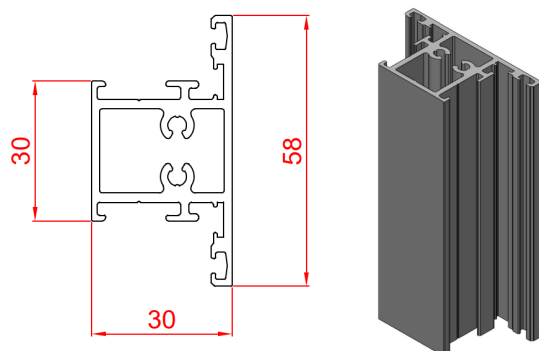

**JID002 Glazing Angle Fixed Outer frame**

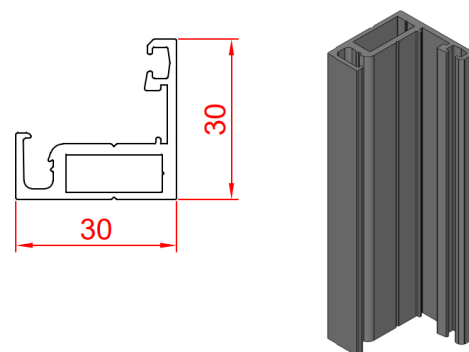

**JID004 Fixed Glazing Bead**

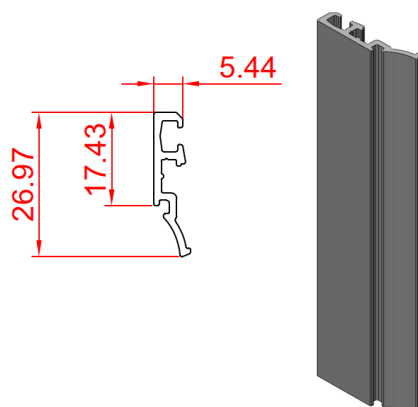

**JID012 Fixed frame transom/mullion**

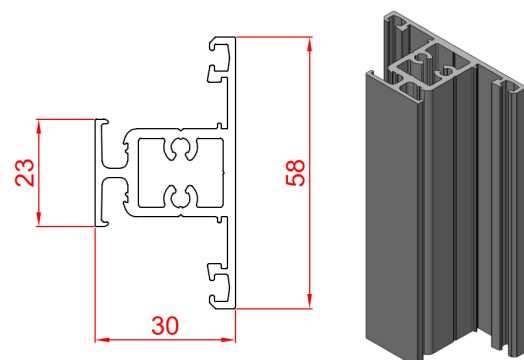

## Profile

**SW60-GB25 Astragal Bar**

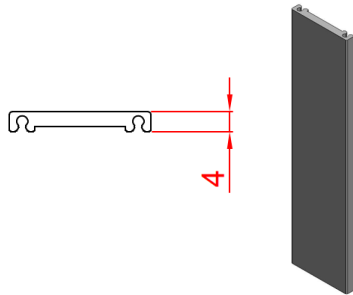

**JID011 Corner Post @ 6m**

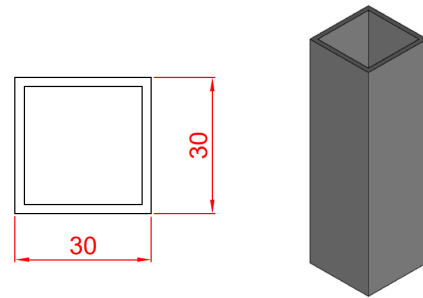

**JID010 45mm coupler @ 3mtr**  
**4mm overall deduction**

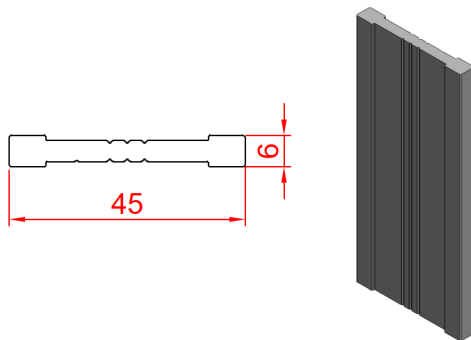

**JID009 77mm Coupler @ 5m**  
**4mm overall deduction**

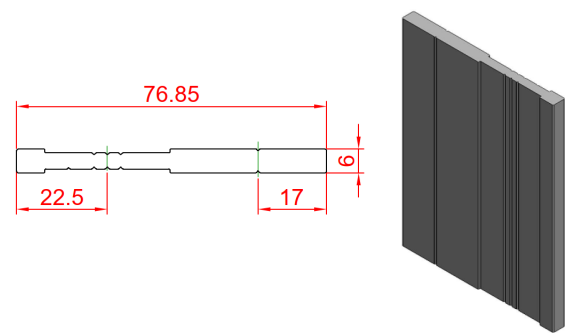

**JID006 Slider Inside Cover 30mmx2mm @ 5mtr**

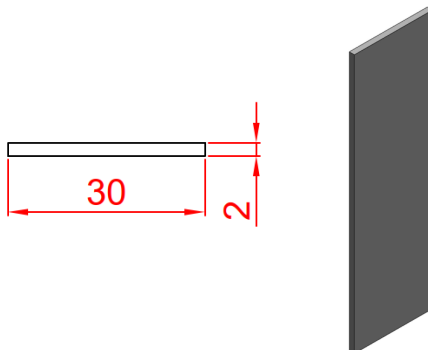

**JID007 Slider Packer 32mm x 6.4mm @ 5m**

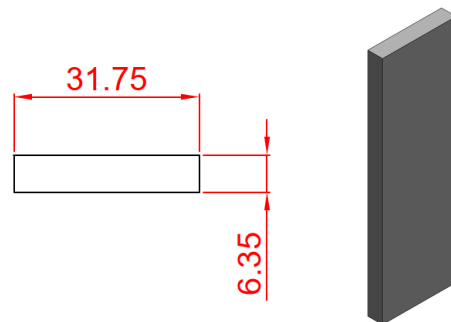

**JID008 Slider Head Cover 63mm x 3.2mm @ 5m**

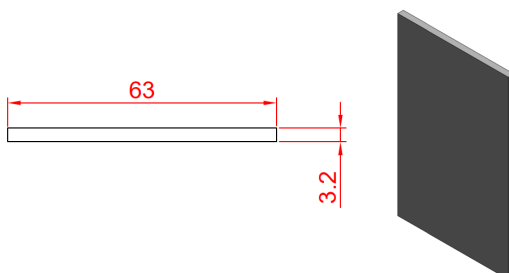

**JID016 Slider Angle 38mm x 38mm @ 5m**

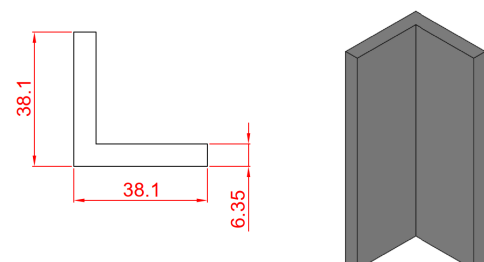

**Profile**

JIDA015 - Floor Guide

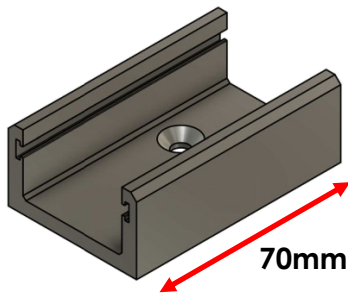

JIDA-WP-4.8x6 Black Woolpile



JIDA-WP-4.8x9.5 Black Woolpile

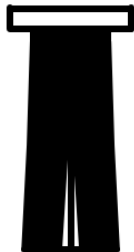

JDA105 DWP Infil Strip



TWAG-002 Bubble Gasket



TWAG-009 Captive Gasket

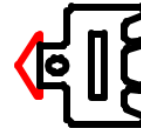

TWAG-005 Wedge Gasket



TWAG-010 Wedge Gasket



TWAG-011 Wedge Gasket



## Cross sections - Hinged Doors

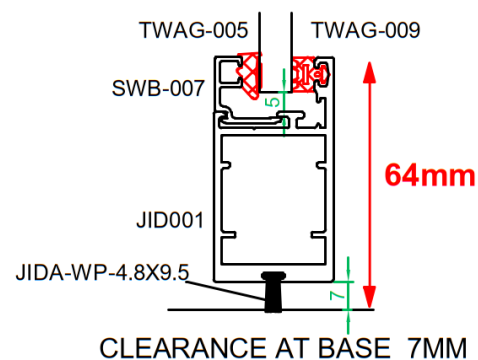
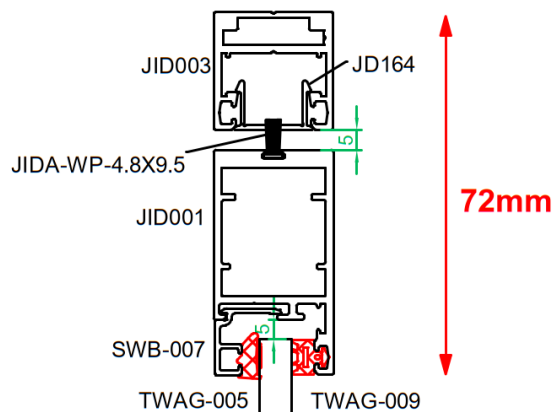
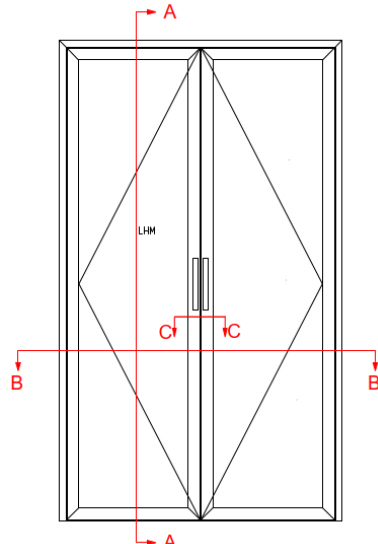
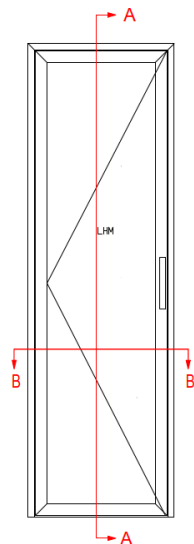

CLEARANCE AT BASE 7MM

**A - A**

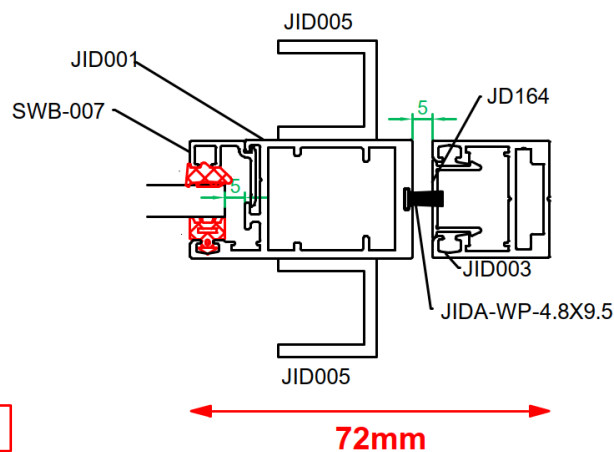
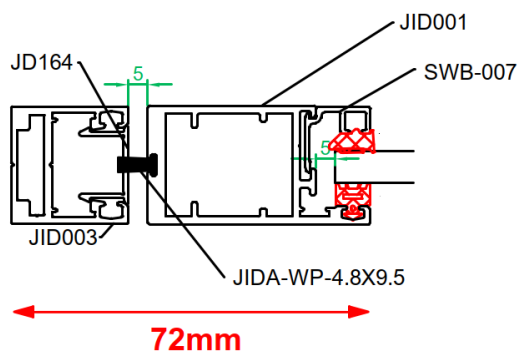

**B - B**

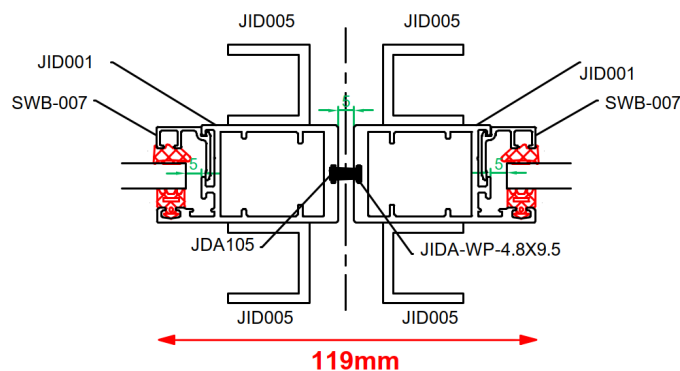

119mm

C - C

### Cross sections - Fixed Panes

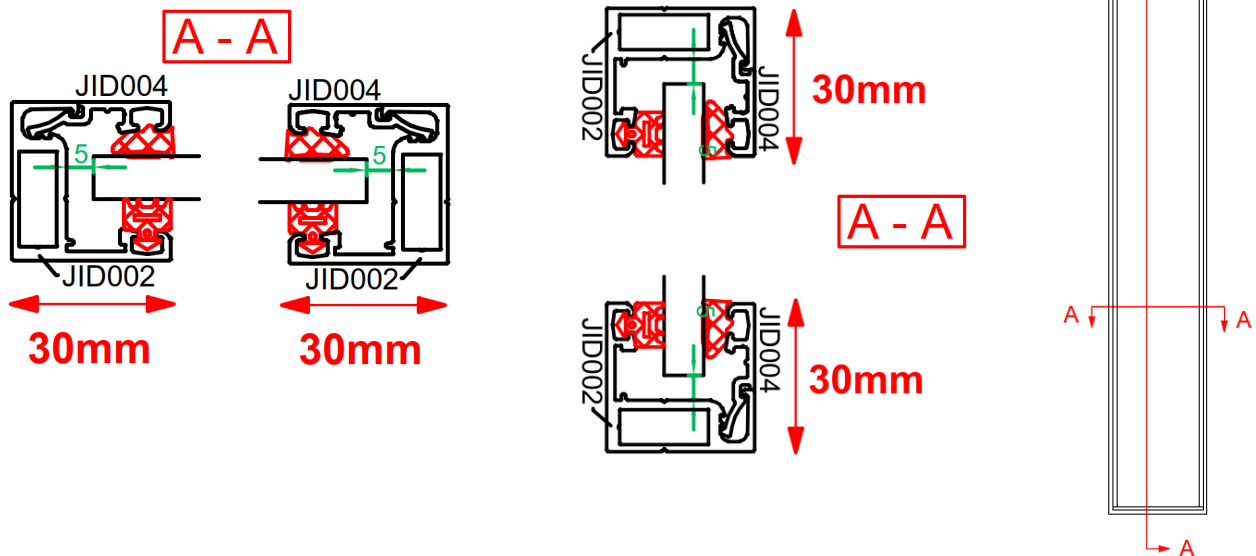

### Cross sections - Coupled Frames

All combination frames, (Doors with side screens and or fanlights are always split and coupled using the **JID010 coupler (4mm deduction)**

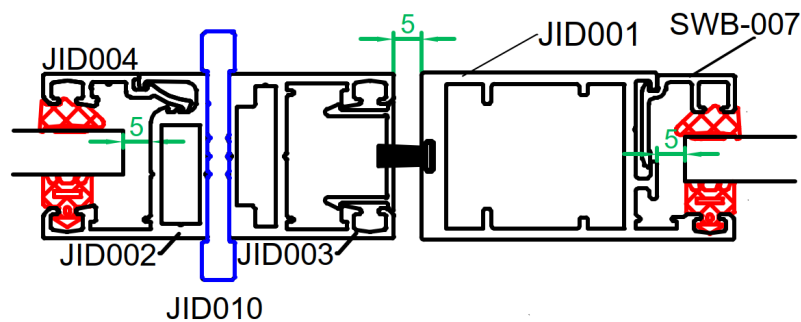

Subject to the design of the combination the horizontal coupler is continuous.

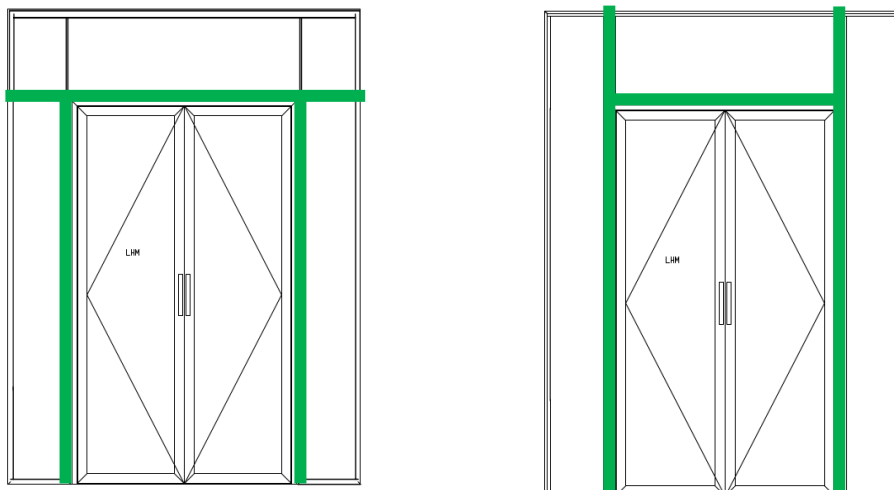

## Cross sections - Sliding doors

### Single Slider / Wall

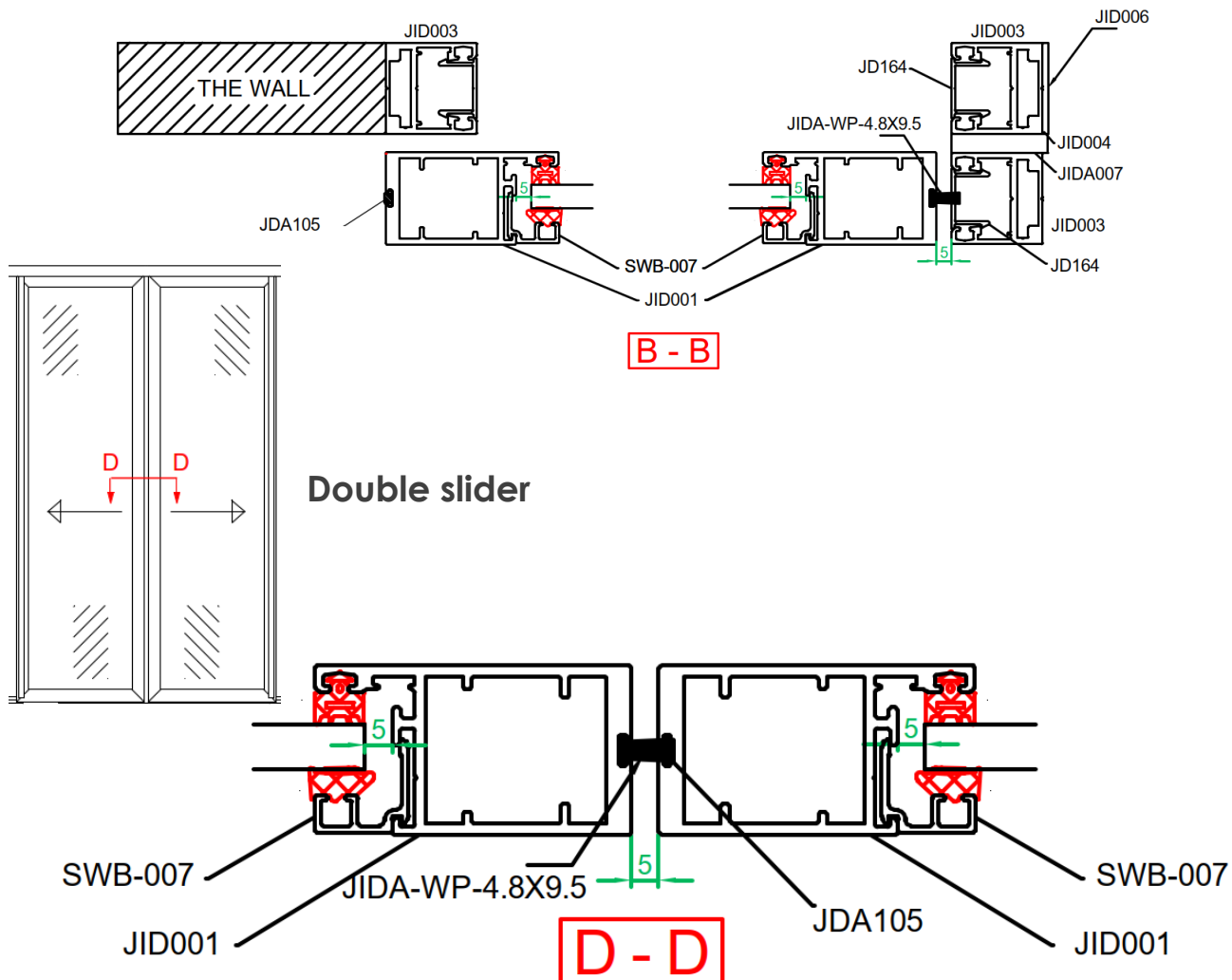
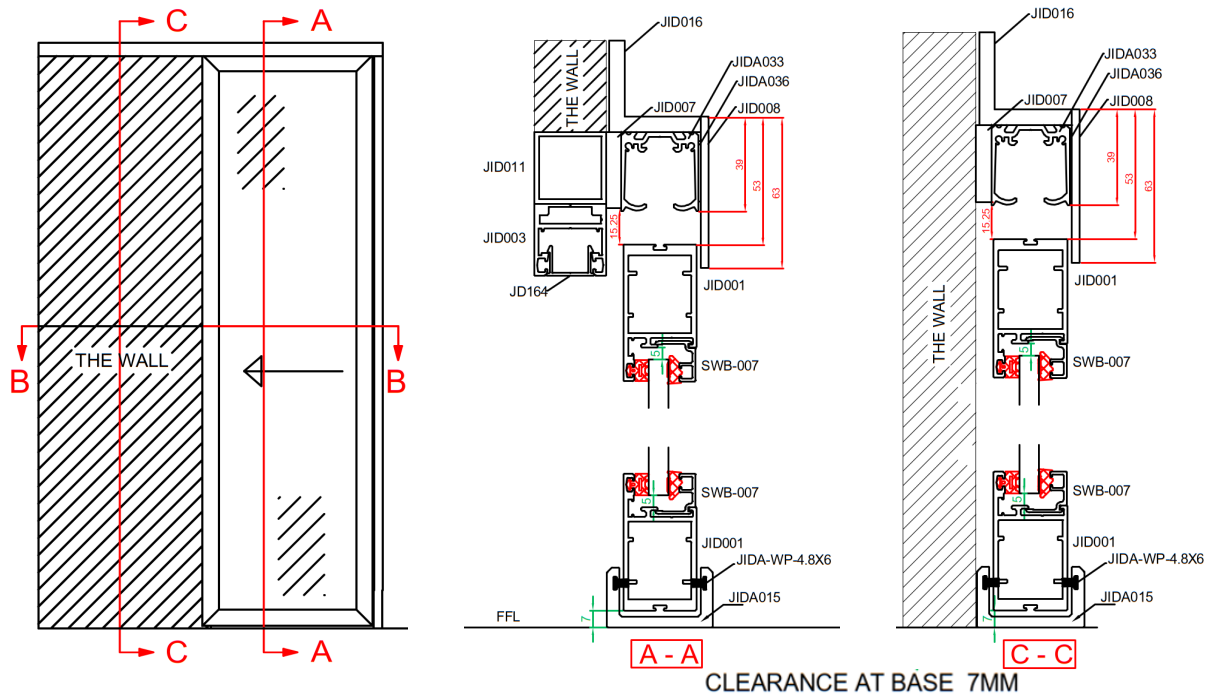



**Cross sections - Sliding doors**  
**Single Slider / Sidelight**

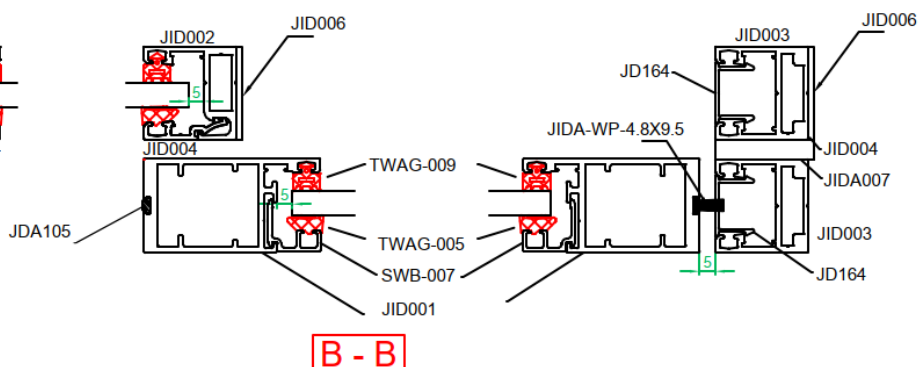
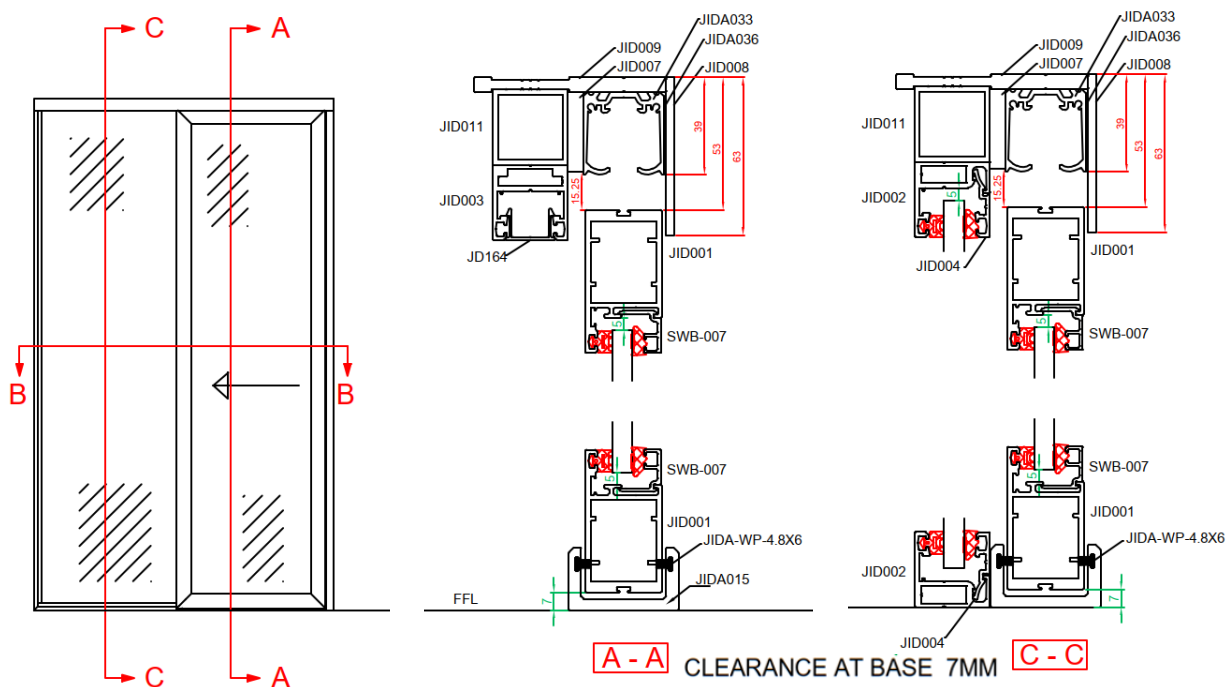

**Single Slider / Sidelight both sides**

A-A & C-C as above

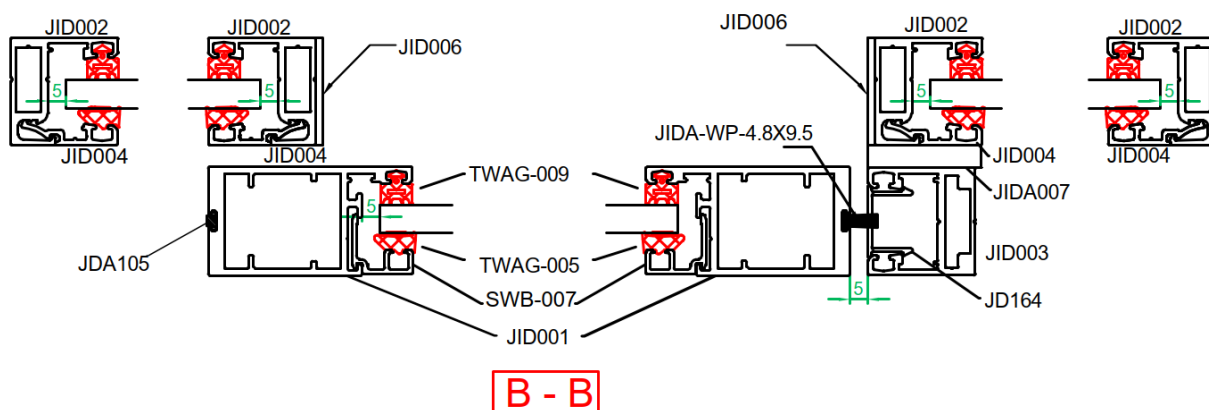
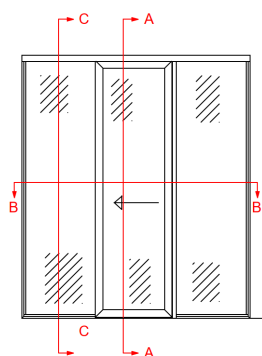

**Cross sections - Sliding doors**

**Fanlight above sliders**

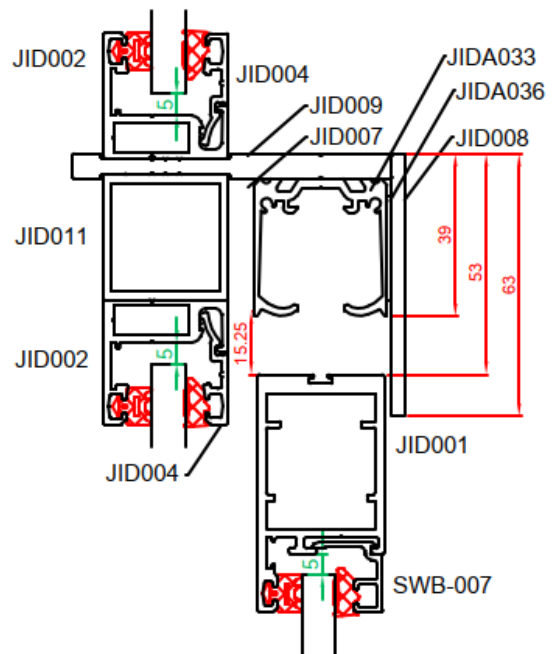
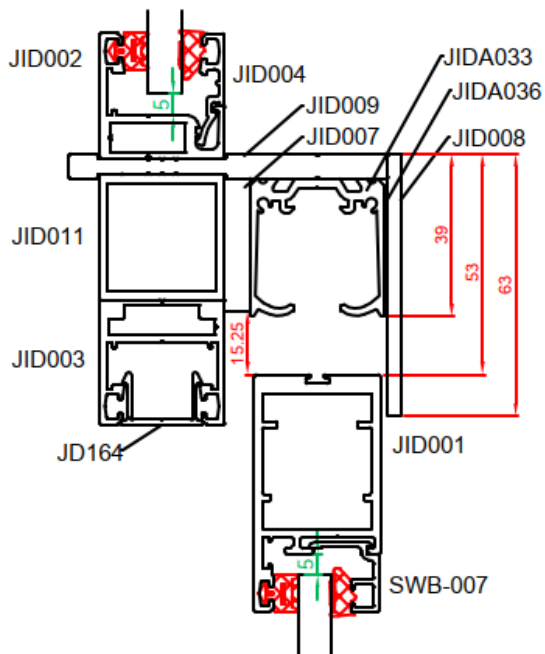
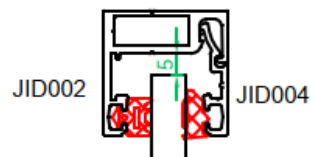
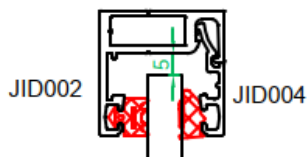
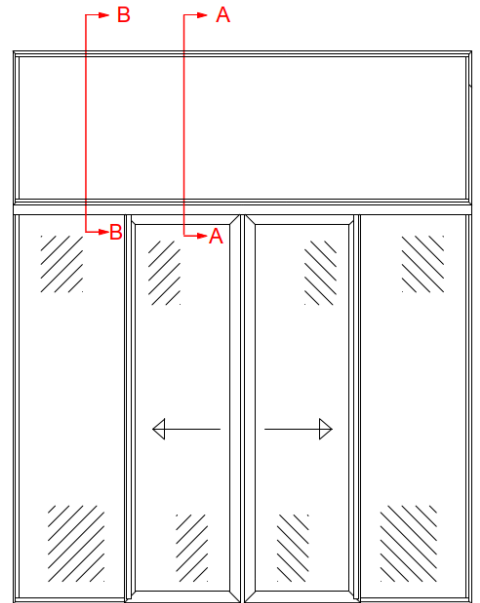

**Cross sections - Pivot doors**

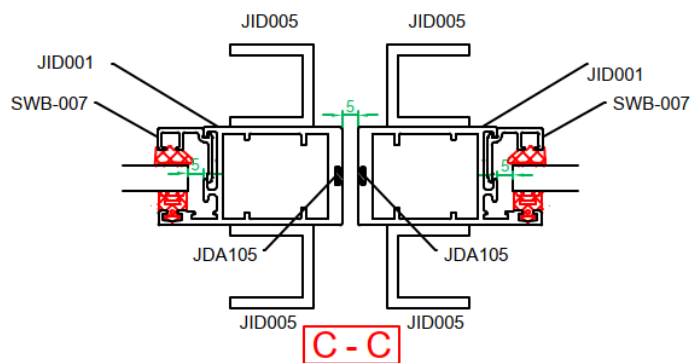
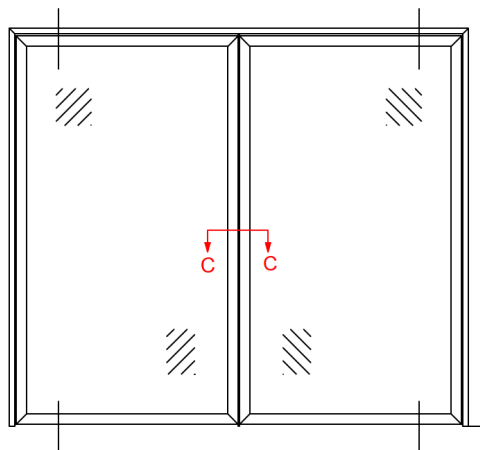
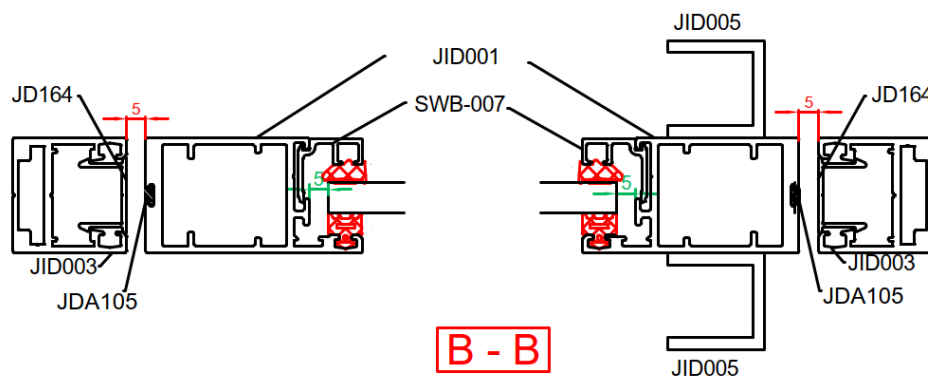
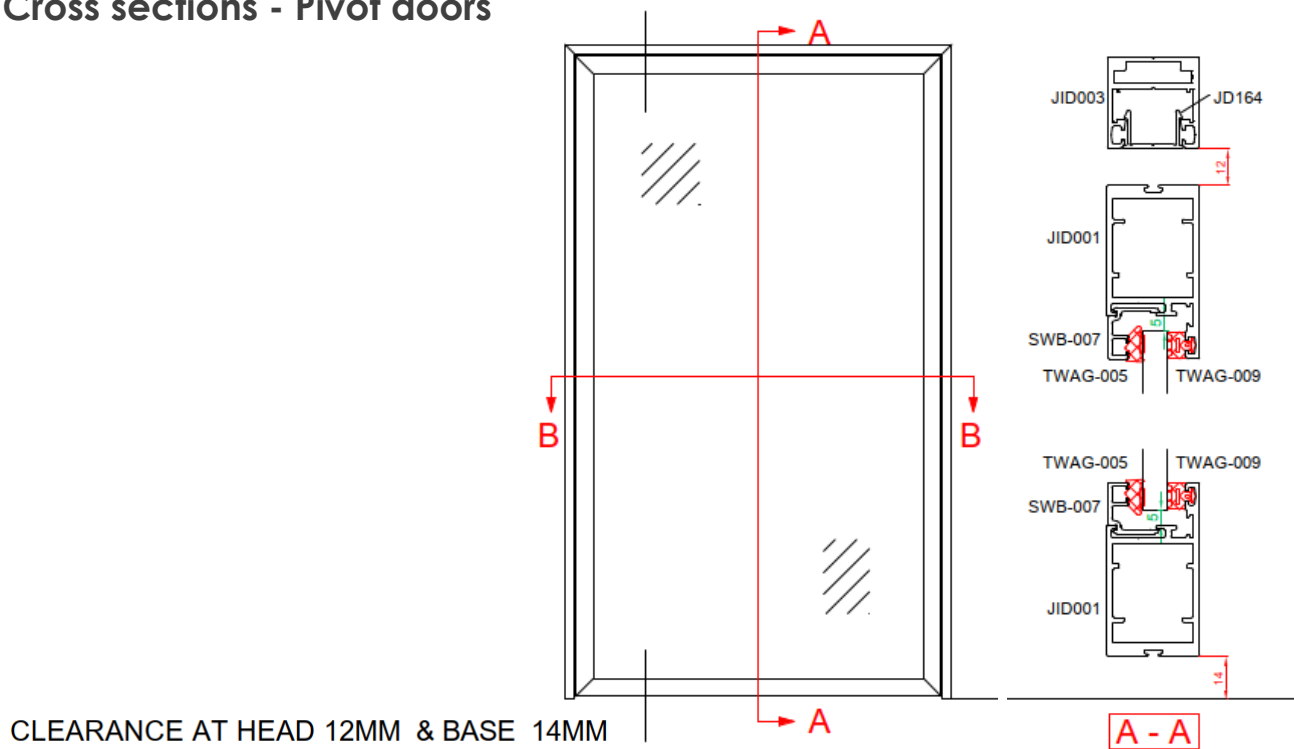

## Glazing

Gasket details for fixed panes and door sashes

6mm / 6.8mm

TWAG-009  
TWAG-010

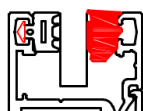

8mm / 8.8mm

TWAG-009  
TWAG-005

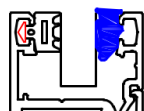

10mm / 10.8mm

TWAG-005  
TWAG-005

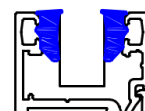

TWAG-005 less tear off strip

## Bridge Packer locations

Hinged & Pivot door

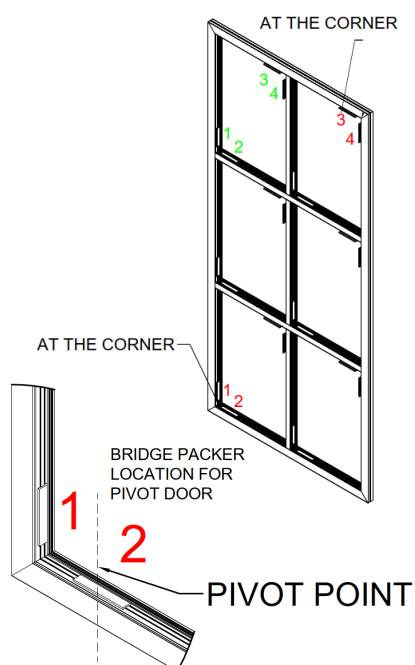

**BRIDGE PACKERS POSITIONS**

**IF TRANSOM  
INSERTED  
FOUR BRIDGE  
PACKERS PER  
PIECE OF GLASS**

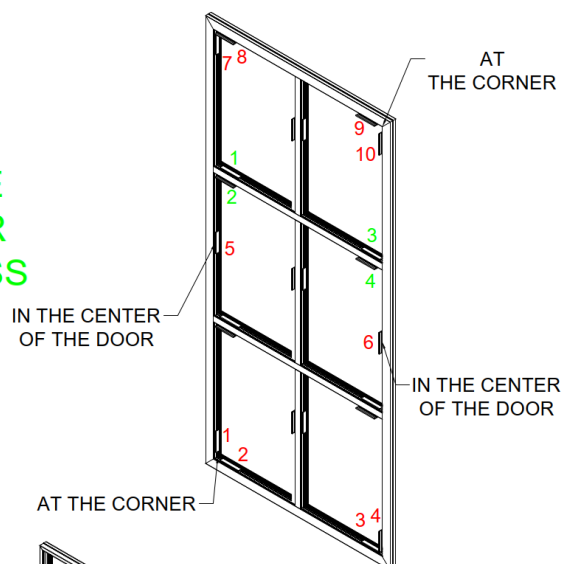

Fixed / Side screen

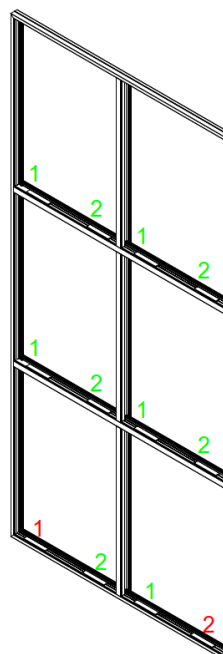
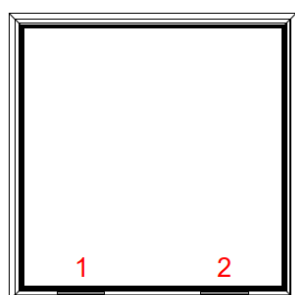

## Door Hinges

Hinges are rebated into the frame and the sash and are hidden. Quantity 3 are fitted to doors are standard.



JIDAHINGE001 - Invisible Hinge

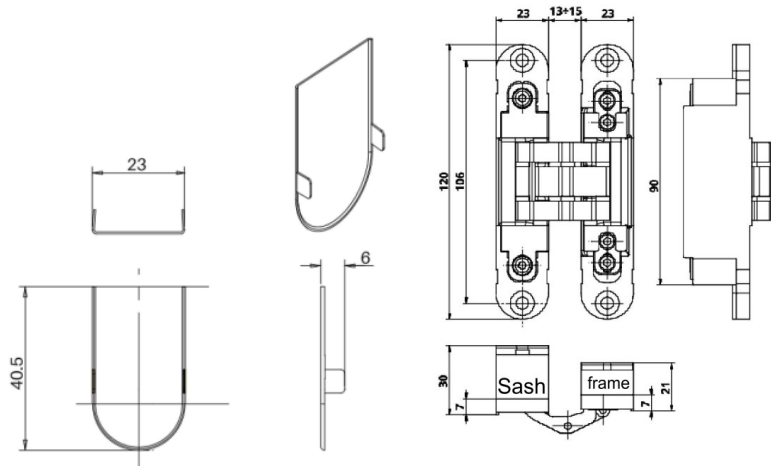

JIDAHINGE002 - Cover Invisible Hinge

**Note:** Hinge and cover are only available in black.

Hinges are fully adjustable, height, depth and side. [See adjustment video](#)

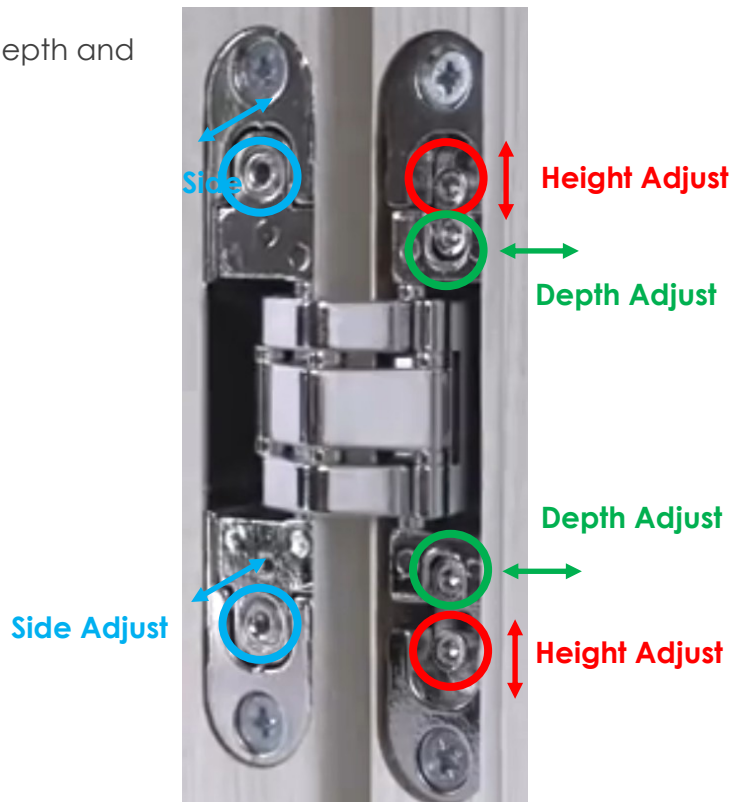

## Magnetic Hold Close - Hinged, Sliding & Pivot

Single doors are supplied with three **JIDA048** magnetic catches as standard (two to the jamb and one to the head). Double doors have one **JIDA048** per sash to the head and two **JIDA046** to the sash. Slave door also has hidden shootbolt top and bottom.

### Single door magnet position

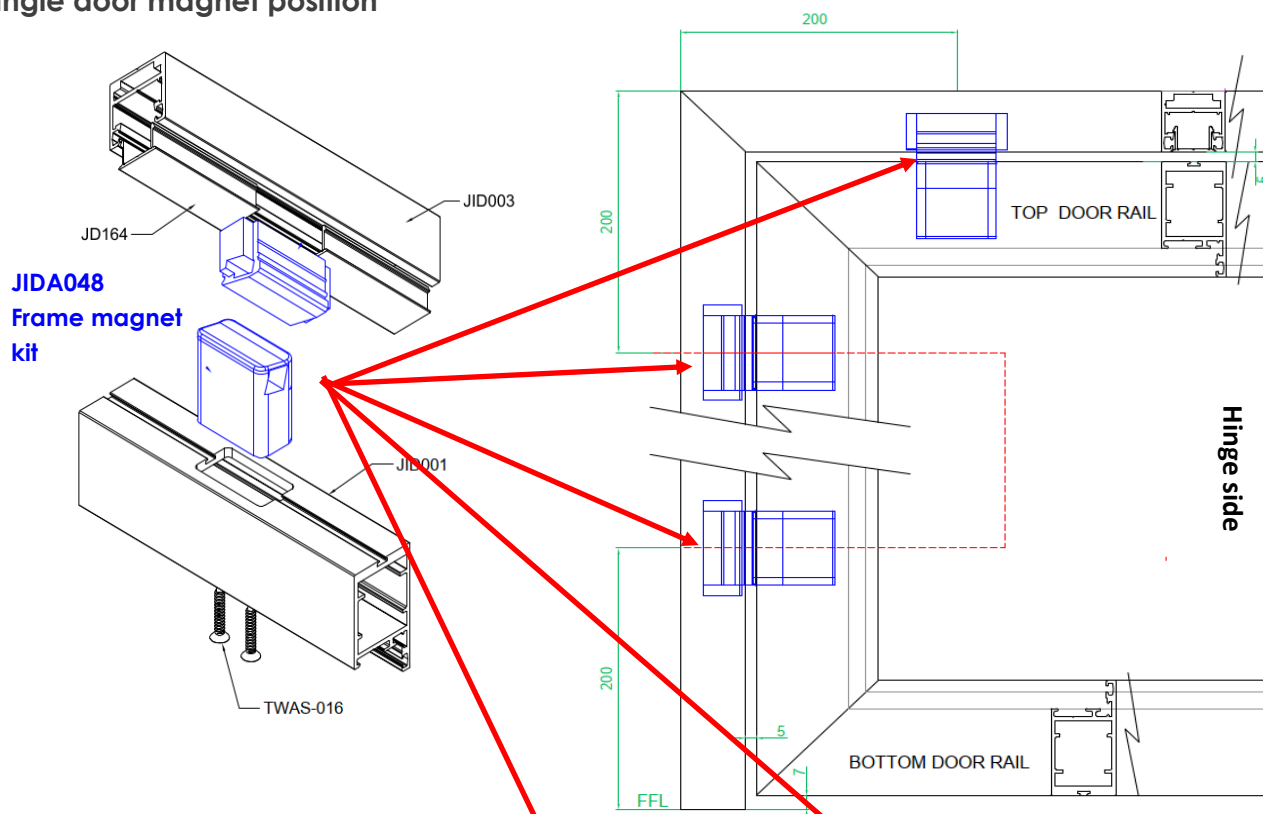

### Double door magnet position

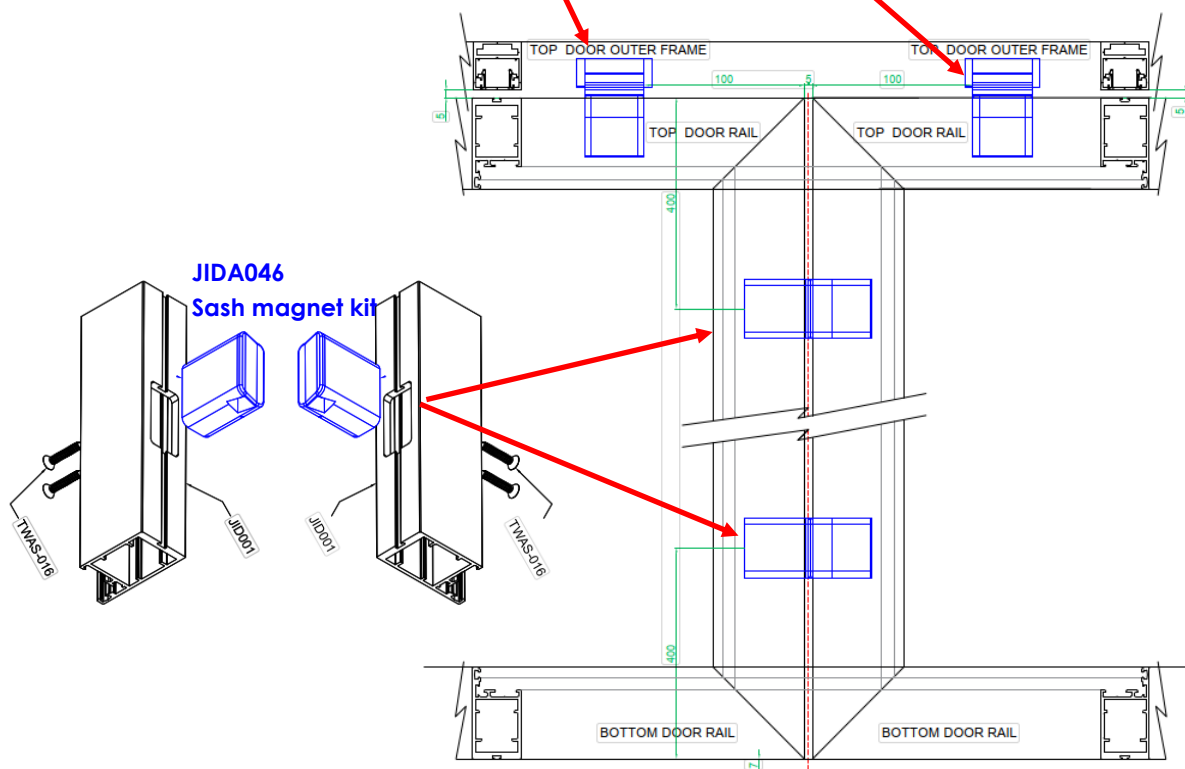

## Double door Hidden Shootbolt to slave

Slave doors on double doors have a hidden shootbolt **JIDA051** top & **JIDA052** bottom.

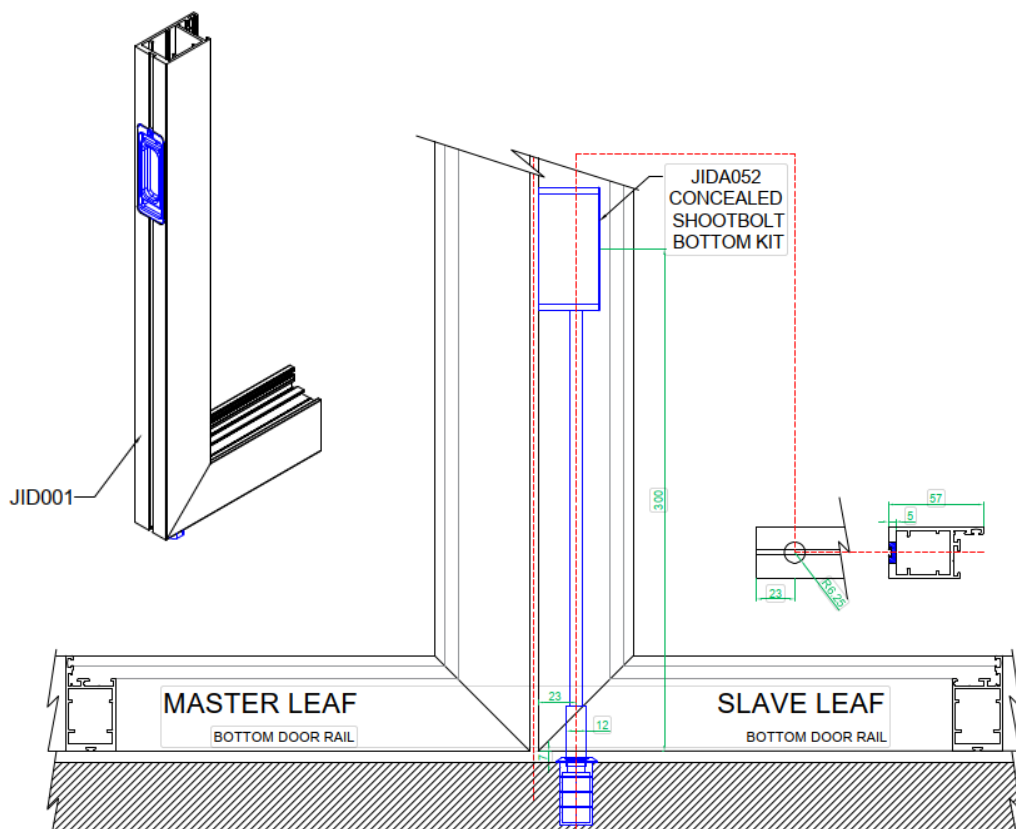
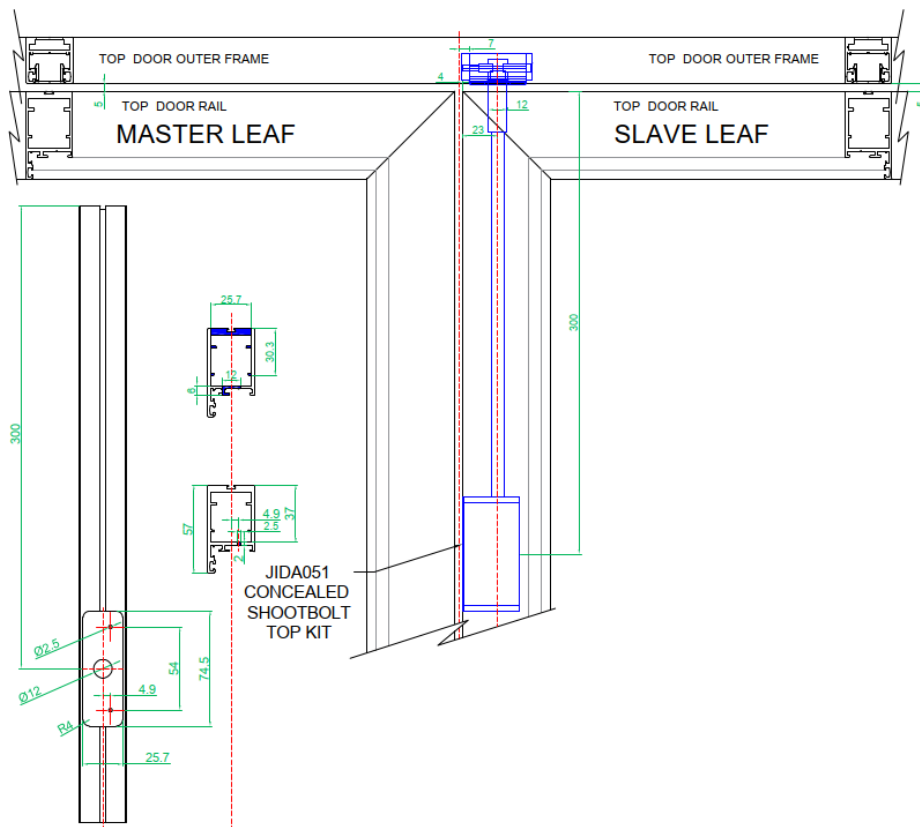

## Door Handles

Channel handle in preset lengths of

JIDAHANLDE016 - 500mm

JIDAHANLDE017 - 400mm

JIDAHANLDE018 - 300mm

This design can also be requested at a longer length.

Lever / Lever handle (pair)

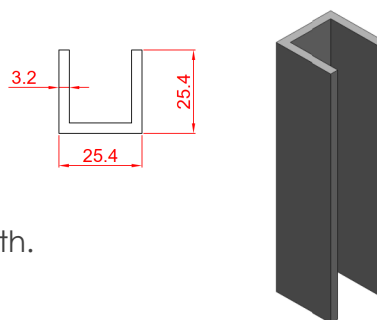

Moveable lever handle but does not operate a mechanism.

JIDAHANLDE015 - Black

JIDAHANLDE015 - White

JIDAHANLDE015 - Satin Silver

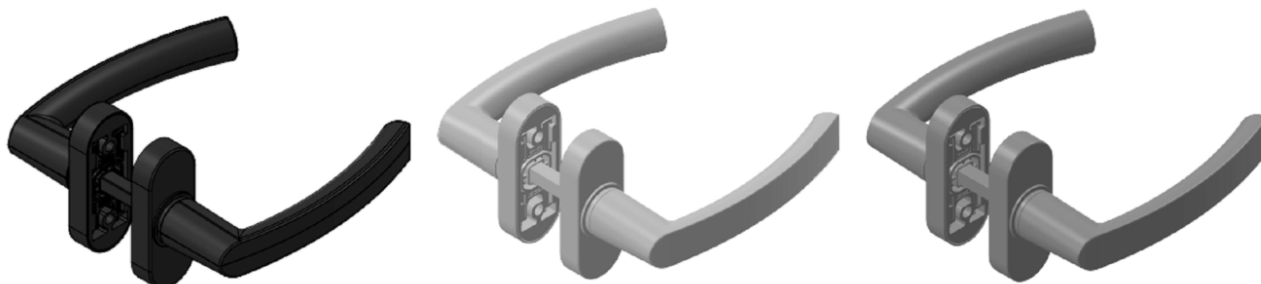

## Slider Door Handles

JIDAHANDLE014 - Black

Sliders also come with soft open / close as standard, this prevents the sash slamming into the wall / locking jamb.

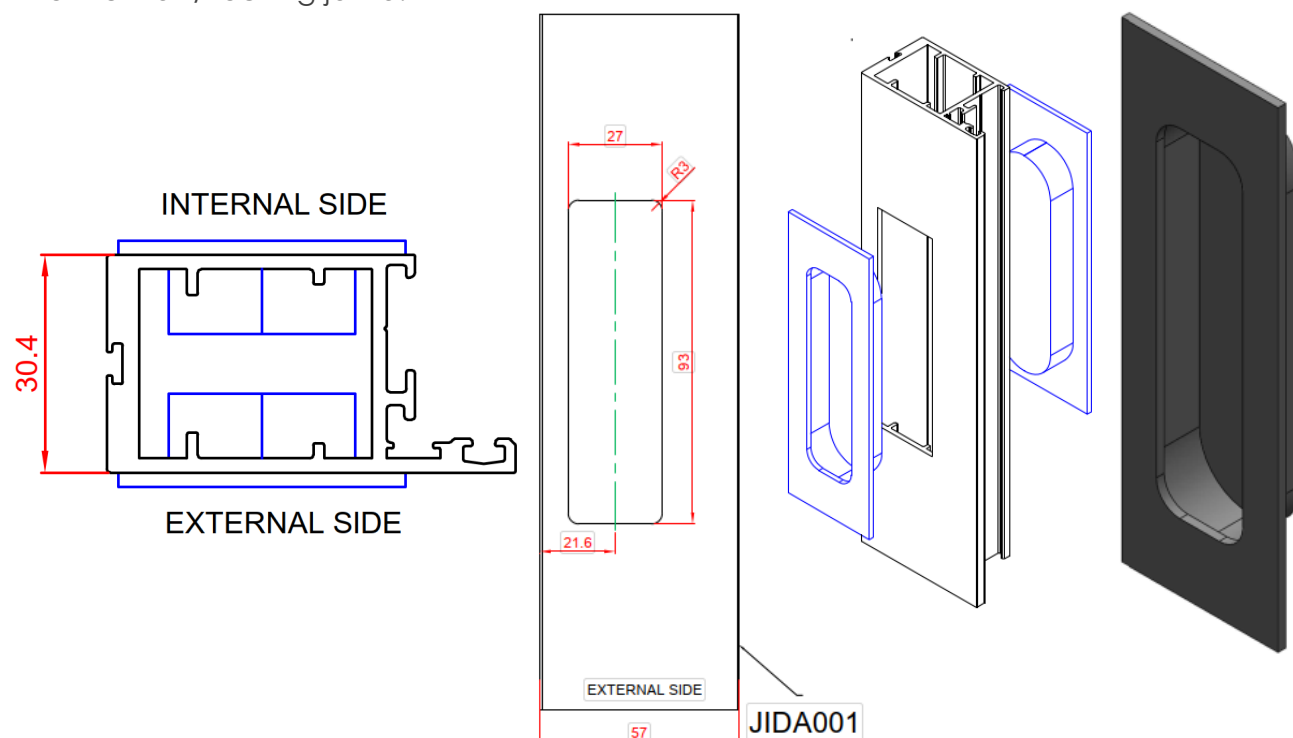



### Profile Chart

JID001  
ID30 DOOR LEAF @ 6.4M

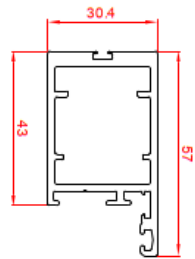

JID003  
ID30 GLAZING CHANNEL @ 6.2M

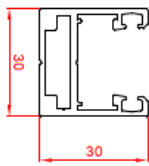

JID002  
ID30 GLAZING ANGLE @ 6.2M

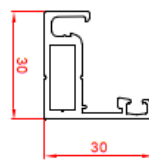

JID004  
ID30 GLAZING BEAD @ 6.2M

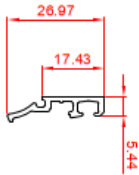

JD164  
SINGLE GLAZE POCKET  
FILLER @ 6.45M



SWB-007  
REBATED SASH BEAD  
INTERNAL @ 6.5M

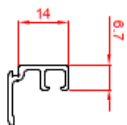

SW60-GB25  
GEORGIAN/ASTRAGAL  
BAR 25MM @ 4M

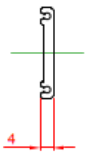

JID016  
ID30 SLIDING ANGLE @ 5M

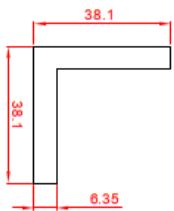

JID005  
ID30 HANDLE BAR 25MM X 25MM X 3.2MM @ 5M

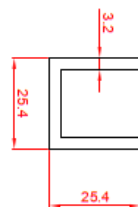

JID006  
ID30 SLIDER SIDE COVER 30MM X 2MM @ 5M

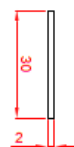

JID007  
ID30 SLIDER PACKER 32MM X 6.4MM @ 5M

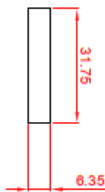

JID008  
ID30 SLIDER HEAD COVER 63MM X 3.2MM @ 5M



JID009  
ID30 77MM COUPLER @ 5M

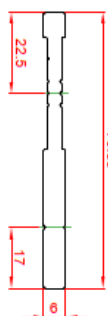

JID010

ID30 45MM COUPLER @ 3M

JID015

ID30 45MM COUPLER @ 5M

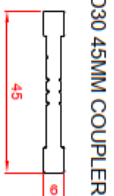

JID012  
ID30 FIXED FRAME  
TRANSOM @ 5M

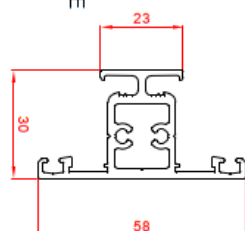

JID013  
ID30 DOOR LEAF  
TRANSOM @ 5M

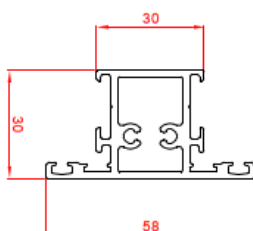

JID014  
ID30 DOOR LEAF  
DUMMY LOCK  
HOUSING @ 5M

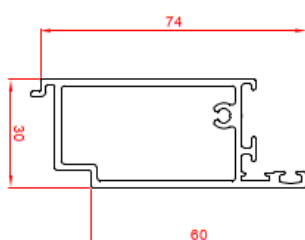

JID011  
CORNER POST @ 6M

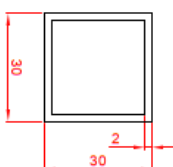

THIS PAGE IS INTENTIONALLY BLANK